

LUGGAGE REAR PLATE : Removal and Installation

INFOID:000000006220260

G

REMOVAL **DO BEFORE LUGGAGE FLOOR TRIM Process (side panel)**

H

1. Open luggage floor board center.
2. Remove luggage floor finishers (LH and RH).
 1. Remove nuts shown by the arrows in the figure.
 2. Disengage luggage floor finisher (1) fixing clip and pawl using a remover tool (A), and then remove luggage side finisher.

○ : Clip
△ : Pawl

Reference : [INTERIOR.pdf](#)

<https://www.facebook.com/download/preview/955151721210696>

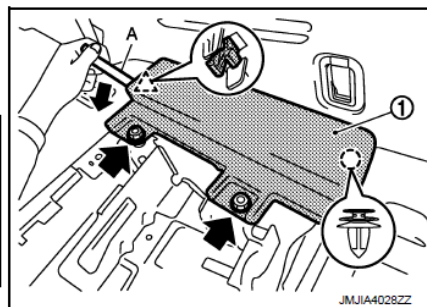

INT

K

3. Disengage luggage rear plate (1) fixing clips and pawls using a remover tool (A), and then remove luggage rear plate.

○ : Clip
△ : Pawl

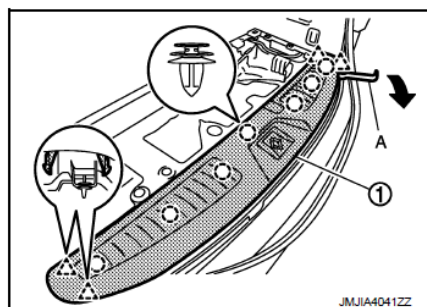

L

M

N

O

P

4. Remove luggage rear plate mask from luggage rear plate.

INSTALLATION

Note the following items, and install in the reverse order of removal.

CAUTION:

- Visually check the clips and pawls for deformation and damage during installation. Replace with new ones if necessary.
- When installing luggage rear plate, check that clips and pawls are securely fitted in body panel holes, and press them in.

LUGGAGE FLOOR TRIM

< REMOVAL AND INSTALLATION >

LUGGAGE SIDE LOWER FINISHER

LUGGAGE SIDE LOWER FINISHER : Removal and Installation

INFOID:000000006220261

REMOVAL

1. Lift up the seat base, tilt seatback forward, and fold down second seat forward.
2. Remove second seat belt anchor. Refer to [SB-13. "SEAT BELT RETRACTOR : Removal and Installation"](#).
- ~~3. Remove third seat. Refer to [SE-136. "Removal and Installation"](#).~~
4. Remove third seat belt anchor. Refer to [SB-19. "SEAT BELT RETRACTOR : Removal and Installation"](#).
- ~~5. Remove luggage floor board center and both luggage floor boards. Refer to [INT-34. "LUGGAGE FLOOR REAR BOARD - Removal and Installation"](#).~~
6. Remove luggage rear plate. Refer to [INT-35. "LUGGAGE REAR PLATE : Removal and Installation"](#).
7. Remove rope hook (1) mounting bolt using a socket wrench (A), and then remove rope hook.

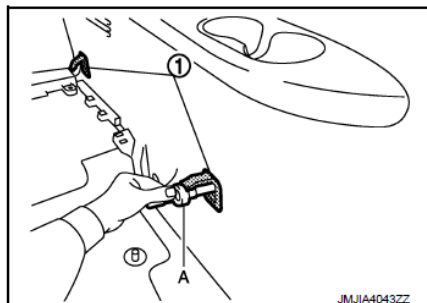

8. Disengage luggage side lower finisher fixing clip (1) using a small flat-bladed screwdriver (A) as shown by the arrow in the figure, and then remove clip.

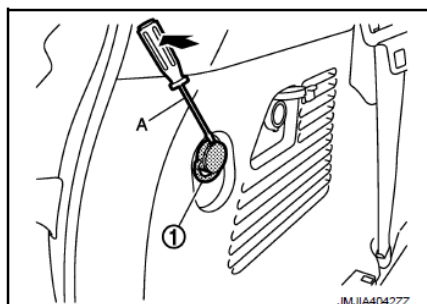

POP the REAR Fixing Clips and the Passenger Door Clips First

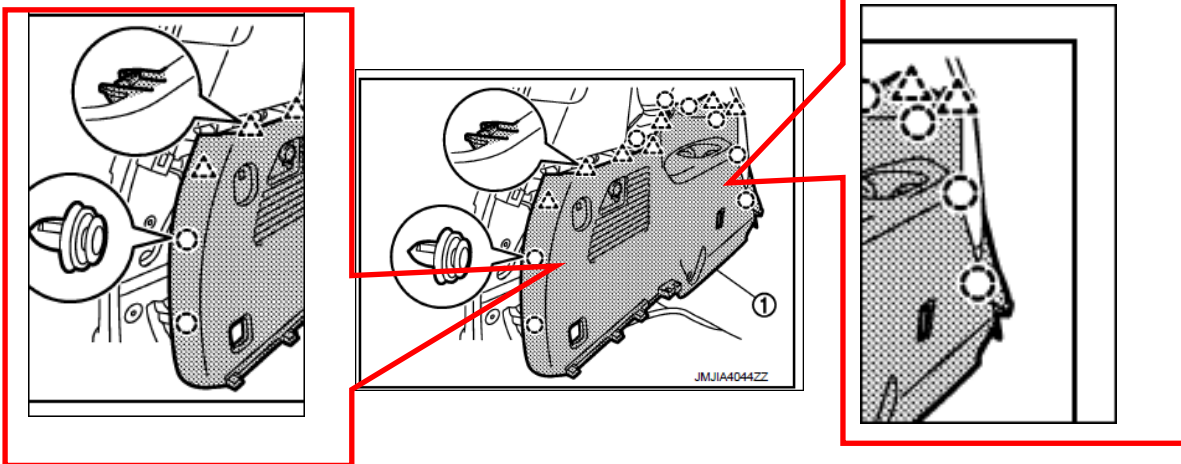

To POP the clips around the curves and under the window , Grab the DRINK Holders and gently but with force firmly pull straight out toward you.

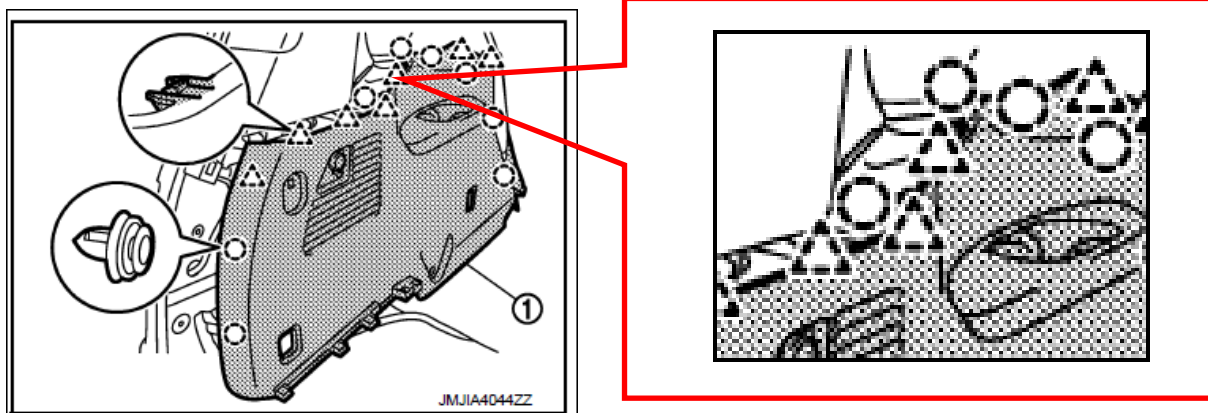

9. Remove luggage side lower finisher.

1. Disengage luggage side lower finisher (1) fixing clips and pawls.

- : Clip
- △ : Pawl

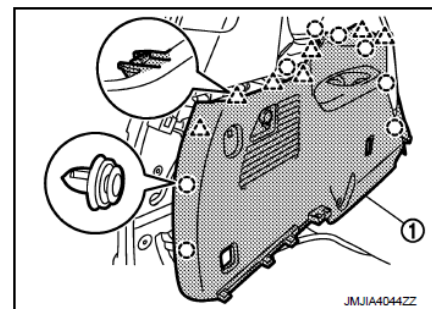

2. Disconnect luggage room power socket harness connector (LH side only).
3. Disconnect fold down switch harness connector (RH side only).
4. Disconnect reclining switch harness connector (LH and RH).
5. Remove luggage side lower finisher.

INSTALLATION

Note the following items, and install in the reverse order of removal.

CAUTION:

Revision: 2010 May

INT-36

2011 QX56

LUGGAGE FLOOR TRIM

< REMOVAL AND INSTALLATION >

- Visually check the clips and pawls for deformation and damage during installation. Replace with new ones if necessary.
- When installing luggage side lower finisher, check that clips and pawls are securely fitted in body panel holes, and press them in.

A